

1

## A- Existing Dwelling Layout

1 : 100

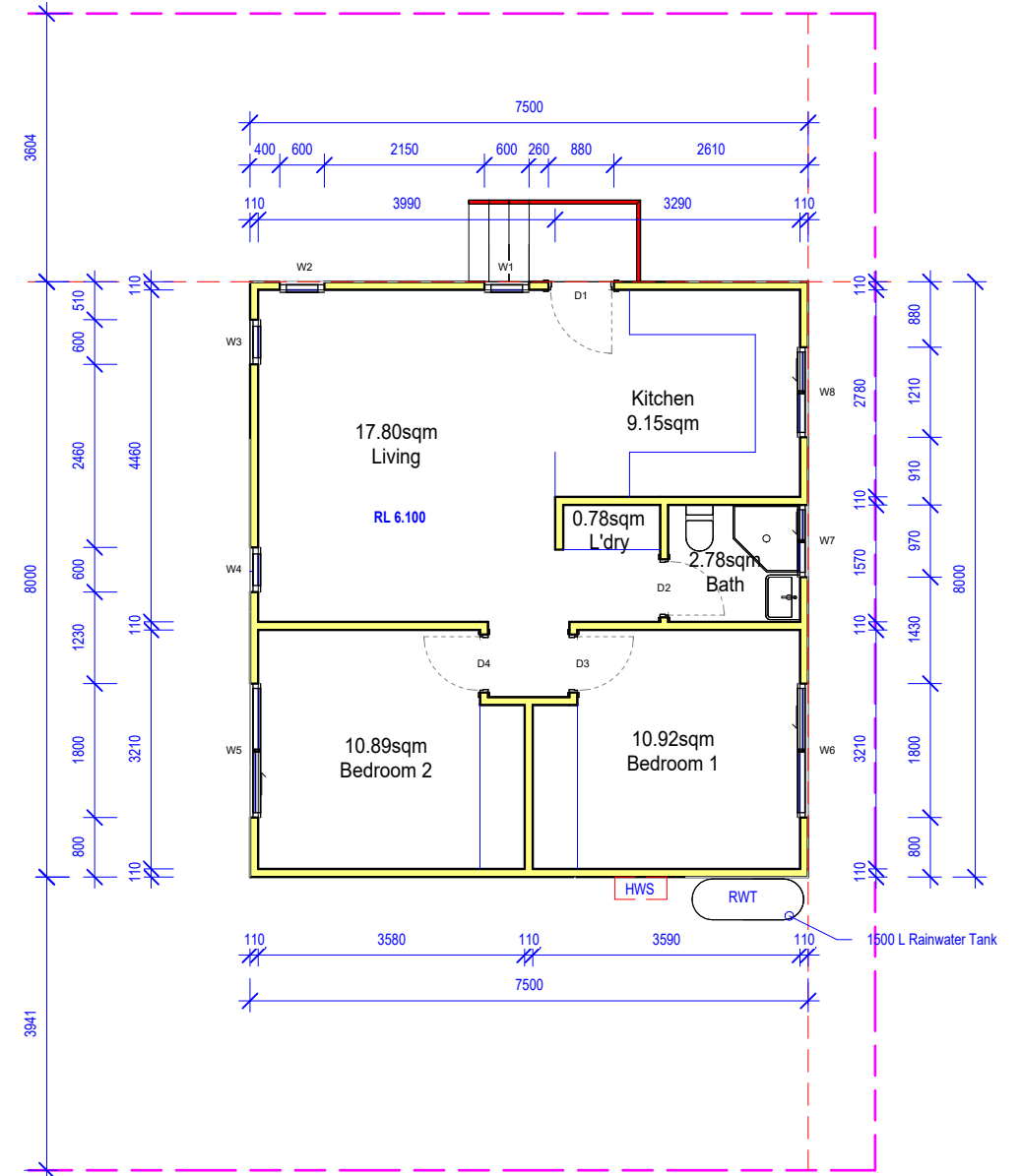

2

## A- Proposed Granny Flat Plan

1 : 100

NOTE:  
\* Architectural documents are to be read in conjunction with relevant structural, fire service, mechanical, hydraulic, electrical, civil and landscaping documents.  
\* Do not scale drawings. Use figured dimensions only. Inform Architect of any conflict between site conditions and documents. Contractor to verify all dimensions on site before commencing work.  
\* Any extra work entailed hereafter must be claimed and approval obtained before proceeding otherwise no extra will be allowed for.  
\* All materials, appliances, fittings and finishes are to be installed in accordance with the manufacturer's recommendations and in compliance with the relevant Codes & Standards.  
\* These drawings are not to be used for construction unless drawings are stamped and endorsed by Building Surveyor.  
\* These documents may only be used for the purposes for which was commissioned and in accordance with the Terms of Engagement.

### CONSULTANTS:

REV	DATE	DESCRIPTION	INITIAL
A	05.12.23	Initial Design	Khaled
B	17.01.24	Issued for DA	Khaled

**DRAWING TITLE:** Ground Floor Plan  
**DRAWN BY:** K.Kabbout  
**CHECKED BY:** K.Kabbout  
**LOT: 3 | SEC:** | **DP:**235638  
**COUNCIL AREA :** Canterbury-Bankstown

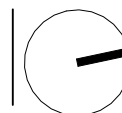

**SITE ADDRESS:** 65 Bullecourt Ave, Milperra  
**CLIENT:** Mr Sleiman  
**ISSUED FOR:** Issued for DA  
**PROJECT TYPE:** Granny Flat  
**SCALE:** 1 : 100  
**DATE:** Oct 2022  
**REV:** B  
**SHEET NO:** 02.0



40 Hector St, Chester Hill NSW, 2162  
www.cedardesign.com.au  
info@cedardesign.com.au  
Phone: 0422 704 479  
A.B.N: 87 616 143 661  
Reg #: 2125/16

PROJECT NO: C2404